



# Compass Directional Guidance, Inc.

*Your Source for Reliable & Modular MWD Technology Systems*

14427 Interdrive West, Houston, TX 77032 • Ph. 281-442-7484 • Fax 832-230-2145 • www.compass-mwd.com

## TECHNICAL DATA SHEET

# EM Isolation Gap Subs

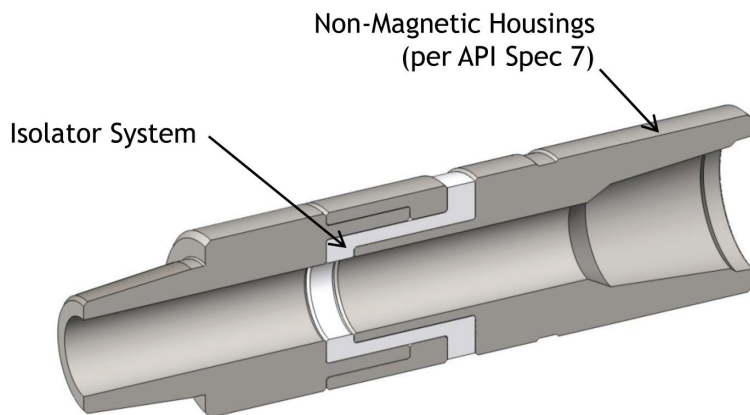
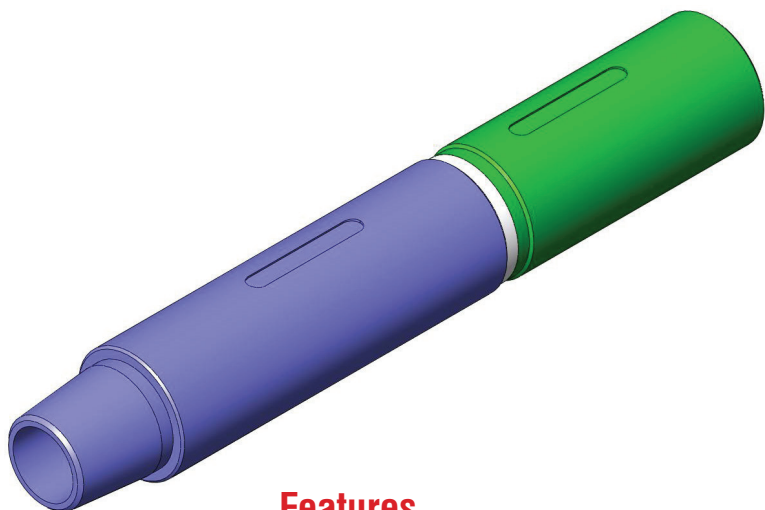

### Features

- No ceramic-coated threads
- No degradation over time of electrical resistance
- Max temp of 175° C (350° F) for all sizes

### EM Isolation Gap Sub Specifications

<b>Sub O.D.</b>	3-3/4"	4-3/4"	6-1/2"	8"
<b>Sub I.D.</b>	2.31"	2.69"	2.81/3.25"	3-1/4"
<b>Length (Shoulder to Shoulder)</b>	39.1"	39.1"	39.1"	39.1"
<b>Length (Pin Shoulder to Mid- Internal Gap)</b>	28.8"	28.8"	28.8"	7.7"
<b>End Threads</b>	2-7/8" SL H-90 Pin X Box or Customer Choice	3-1/2" IF Pin X Box or Customer Choice	4-1/2" XH Pin X Box or Customer Choice	6-5/8" Reg Pin X Box or Customer Choice
<b>Max Downhole Pressure</b>	25,000 PSI	25,000 PSI	20,000 PSI	15,000 PSI
<b>Max Pull and Reuse</b>	175,000 lbs	273,000 lbs	743,000 lbs	1,161,000 lbs
<b>Max Pull Before Failure</b>	191,000 lbs	298,000 lbs	811,000 lbs	1,271,000 lbs
<b>Max Operating Torque</b>	5,500 lbs/ft	9,500 lbs/ft	24,000 lbs/ft	48,000 lbs/ft
<b>Max Dogleg Severity (Rotating)</b>	20°/100 ft	15°/100 ft	10°/100 ft	9°/100 ft
<b>Max Dogleg Severity (Sliding)</b>	40°/100 ft	30°/100 ft	20°/100 ft	17°/100 ft